

Catalog Page 93-1

.100	Jumper	Single Shunt	Insulated	
------	--------	--------------	-----------	--

.100 inch Center Microshunt Open & Closed Top Single Jumper

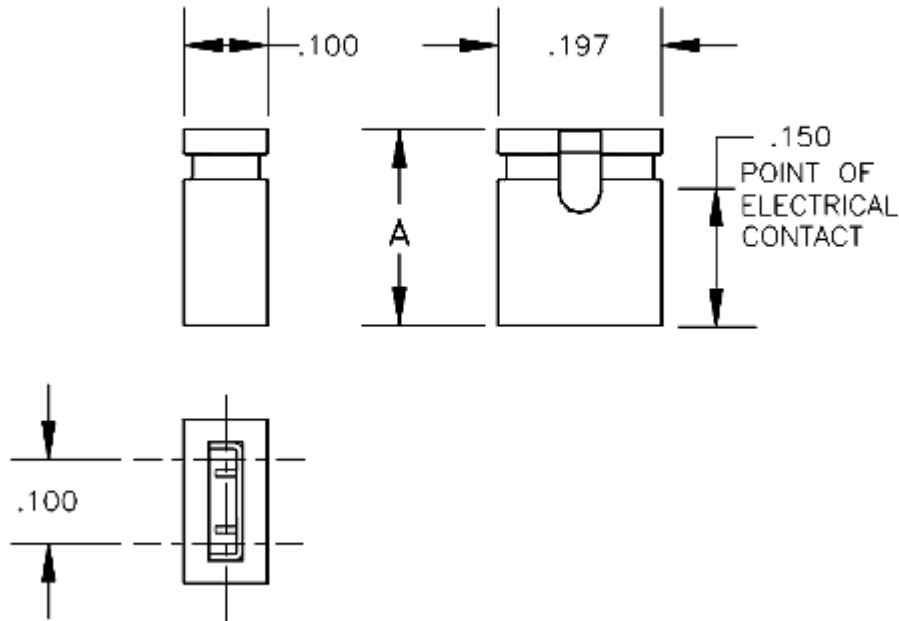

Base Part Number	A		B		C		D		E		Plating Options	Number of Positions
	mm	Inch	mm	Inch	mm	Inch	mm	Inch	mm	Inch		
CCIJ-185 Open Top	4.70	0.185									T : G	OPEN TOP
CCIJ-235 Open Top	5.97	0.235									T : G	OPEN TOP
CTIJ-255 Closed Top	6.48	0.255									T : G	CLOSED TOP
CCIJ-315 Open Top	8.00	0.315									T : G	OPEN TOP
CTIJ-315 Closed Top	8.00	0.315									T : G	CLOSED TOP

Technical Notes	
Contact Material:	Phosphor Bronz
Insulation Material:	Thermoplastic 94-VO rated
Insulation Resistance:	5000 MegOhm @ 500VDC
Current Rating:	1 amp continuous @ 100 VDC/contact
Max Processing Temp:	105°C for 60 seconds

Insertion Force:	200 grams (7.0oz) (typ initial force per shunt pair w/ .020 inch sq pin)
Extraction Force:	120 grams (4.2oz) (typ initial force per shunt pair w/ .020 inch sq pin)

COMM CON CONNECTORS INC.

1848 Evergreen Street, Duarte, Ca 91010 · (626) 301-4200 · fax (626) 301-4212 · e-mail:
info@commcon.com