

Use this browser's print function to print this entire page, then close this window.

Catalog Page 79-2

Hi Temperature Plastic

2mm	Socket	Double Row - SMS Extender	Straight	Thru Hole
-----	--------	---------------------------	----------	-----------

2mm Center, Double Row Straight, Extender, using Screw Machine Contacts

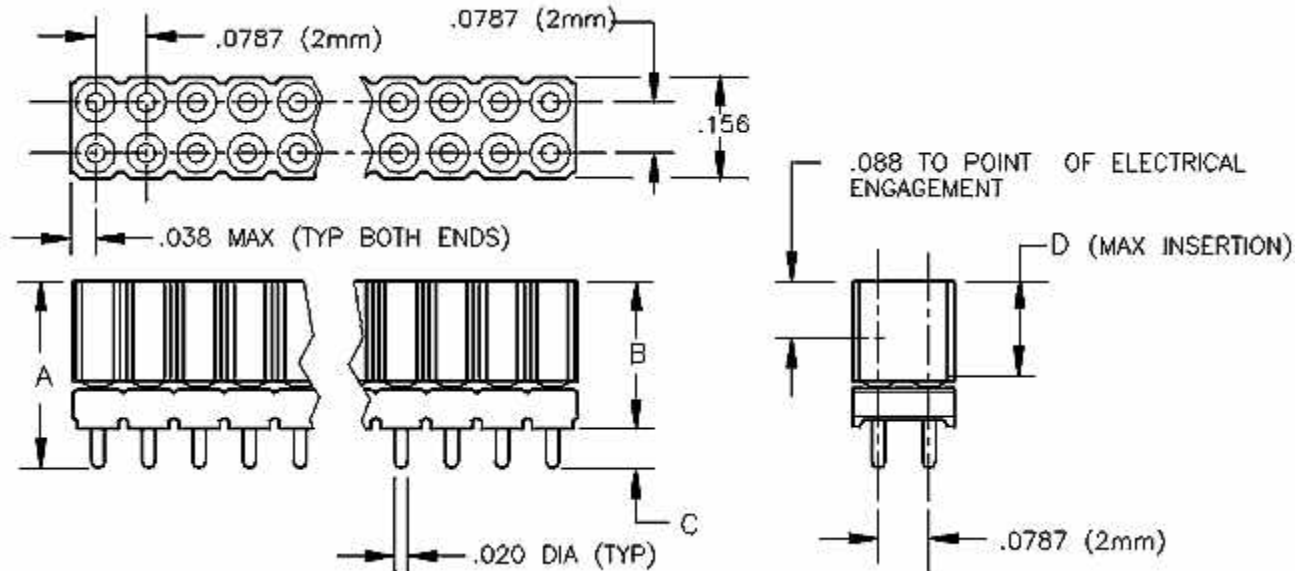

Base Part Number	A		B		C		D		E		Plating Options	Number of Positions
	mm	Inch	mm	Inch	mm	Inch	mm	Inch	mm	Inch		
1255	9.14	0.360	6.22	0.245	2.92	0.115	3.81	0.150			G2 : T	4-100
1259 Non-Stack	11.68	0.460	9.35	0.368	2.34	0.092	5.08	0.200			G2	4-100
1257	13.08	0.515	10.54	0.415	2.54	0.100	3.81	0.150			G2 : T	4-100
1256	13.08	0.515	8.89	0.350	4.19	0.165	3.81	0.150			G2 : T	4-100
1260 Stackthrough	21.34	0.840	9.35	0.368	11.99	0.472	5.08	0.200			G1	4-100

Technical Notes

Contact Material:	Shell: Phosphor Bronz, Contact Clip: 6 finger BeCu [#32]
Insulation Material:	Glass Filled Nylon 46, UL 94V-0 rated, Black (std)
Heat Deflection:	260°C @ 264 PSI per ASTM D648
Insulation Resistance:	5,000 MegOhm @ 500VDC
Current Rating:	3 amp continuous @ 100 VDC/contact
Max Processing Temp:	250°C for 60 seconds
Insertion Force:	Typ initial per: 160 grams (5.6oz) w/.020" rd pin & 209 grams (7.4oz) w/.020sq pin [#32]
Extraction Force:	typ initial per: 97 grams(3.4oz) w/.020" rd pin & 116 grams(4.1oz) w/.020sq pin [#32]

COMM CON CONNECTORS INC.

1848 Evergreen Street, Duarte, Ca 91010 · (626) 301-4200 · fax (626) 301-4212 · e-mail: info@commcon.com